

# EASY MIX

FIXED-POINT LATERAL MODULATING THERMOSTATIC MIXING VALVE, FOR HEATING SYSTEMS

The De Pala thermostatic mixing valve from the EASY MIX series offers high performance in medium and low temperature heating circuits. Its specific design makes it extremely versatile, defining it as a "full range" mixer: from radiators to fan coils and radiant systems, it can be used in both traditional floor systems and innovative ceiling and wall systems.

The possibility of setting operating temperatures even below 30°C, i.e., at very low flow settings, allows the system to be kept at the correct and continuous temperature even with low thermal loads, ensuring a high level of environmental comfort and energy savings. In this case, the optimal working range is from 20° to 55°C. These values include the most different set points in radiant applications in the residential sector.



## □ HOW THE VALVE WORKS

The internal thermostatic element, containing a special heat-sensitive wax, reacts to the water temperature by expanding or contracting. These movements are transferred to an integral shutter that partially closes the inlet ports for hot water from the heat generator and cold water returning from the system, depending on the temperature of the mixed flow that touches the element.

The temperature mixed in this way is kept constant and any deviations from the desired set point, caused by variations in the inlet temperatures, are immediately corrected thanks to the extremely rapid reaction capacity of the thermosensitive wax. A practical graduated knob allows you to set the set point temperature of the mixed flow. An equally simple and ingenious red locking ring allows you to lock the knob in the position that the installer has set for the system, without the need for tools or complicated procedures, preventing subsequent accidental misalignment or tampering.

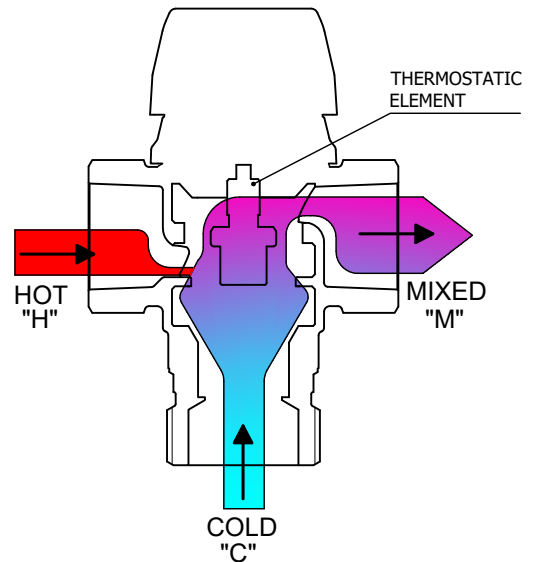

## □ SET POINT ADJUSTMENT AND SAFETY LOCK

The setting is adjusted by turning the upper black knob clockwise/counterclockwise. The graduated scale on the top of the knob shows the desired setting.

Match the desired setting with the red **arrow index** on the locking ring below.

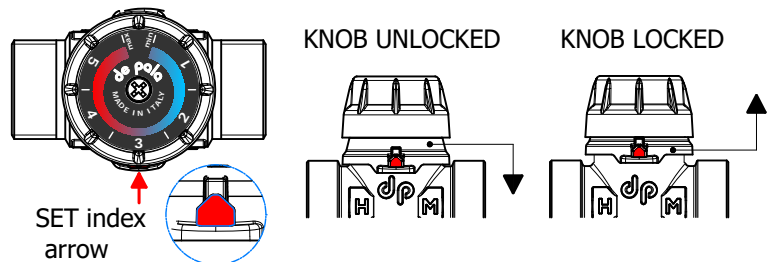

**When the system is first put into service, the SET must be checked at operating speed (using a suitable measuring instrument) and corrected if necessary. The indicative adjustment references shown on the knob are given on the side:**

USE	TEMPERATURE SETTING REQUESTED DELIVERY	INDICATIVE ADJUSTMENT OF THE KNOB
Radiant	20° ÷ 45°C	SET <b>MIN</b> ÷ SET <b>4</b>
Fan Coil	40° ÷ 55°C	SET <b>3</b> ÷ SET <b>5</b>
Radiators	50° ÷ 55°C	SET <b>5</b> ÷ SET <b>MAX</b>

## ☐ DIMENSIONS / CONNECTIONS

CODE	SERIES	TEMPERATURE RANGE SET	Kvs	DIMENSIONS				
				D (")	A (mm)	B (mm)	C (mm)	E (mm)
MT10	EASY MIX	20 ÷ 55°C	3	G 1" M	61,6 ± 3,5	62,5	84,5	54
MT10B			G 3/4" B	92,5		144,5		
MT54			G 1"1/4 M	62,5		84,5		
MT54B			G 1" B	97		153,5		
MT54F			G 1" F	62,5		84,5		

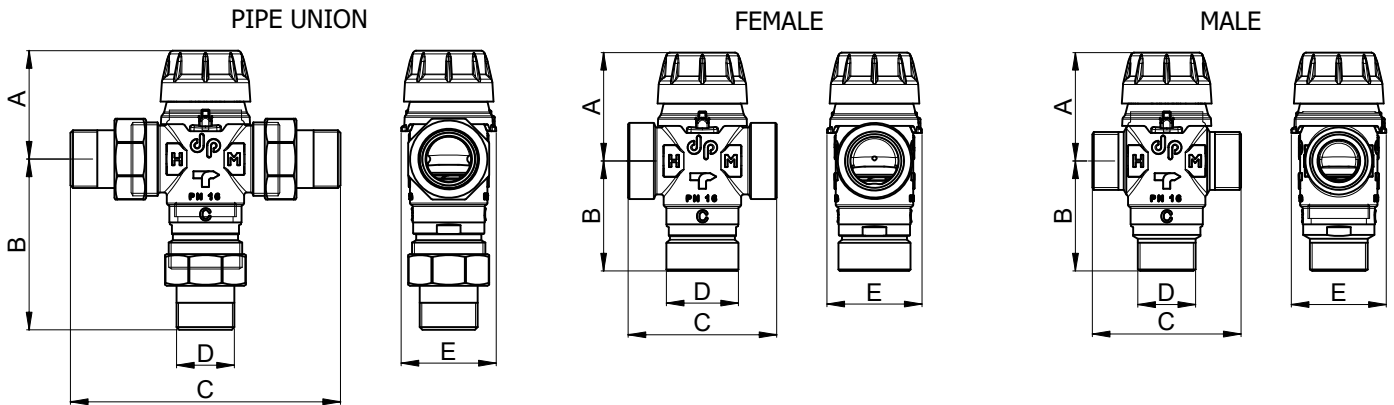

## ☐ PRESSURE DROP DIAGRAM

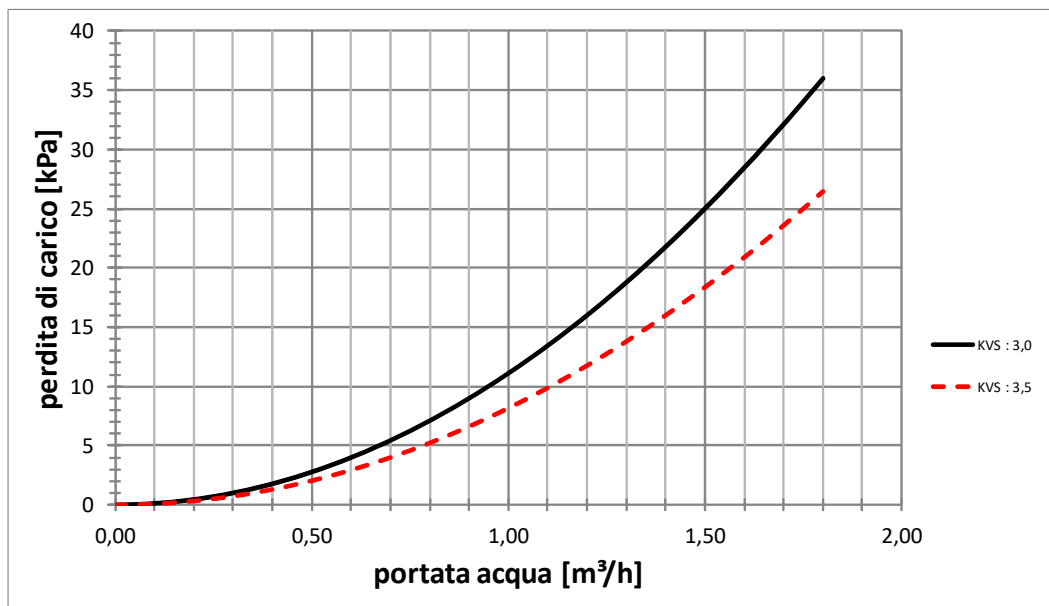

## ☐ TECHNICAL SPECIFICATIONS

- Maximum operating pressure : 16 bar
- Maximum water inlet temperature : 85°C
- Set point adjustment range : 20°C ÷ 55°C
- Accuracy 1 : ± 1,5°C with set point (M) 20°÷35°C and hot water inlet (H) ≥ 50°C
- Accuracy 2 : ± 2,5°C with set point (M) 35°÷55°C and hot water inlet (H) ≥ 70°C
- Fluids used : Clean water (without solid/abrasive particles) - Max glycol 50%

### Material:

- Valve body : CW617N brass (UNI EN 12165)
- Springs : Stainless steel
- Sealing elements : EPDM
- Adjustment knob : Polyamide 6.6 - glass-filled
- Sensitive element : Heat-sensitive wax

**POSSIBLE INSTALLATIONS AND ORIENTATION INDEX**

**SUPPLY STATUS**  
flow M towards **DX** - SET index visible:

If you wish to **REVERSE** the flow,  
follow these steps:

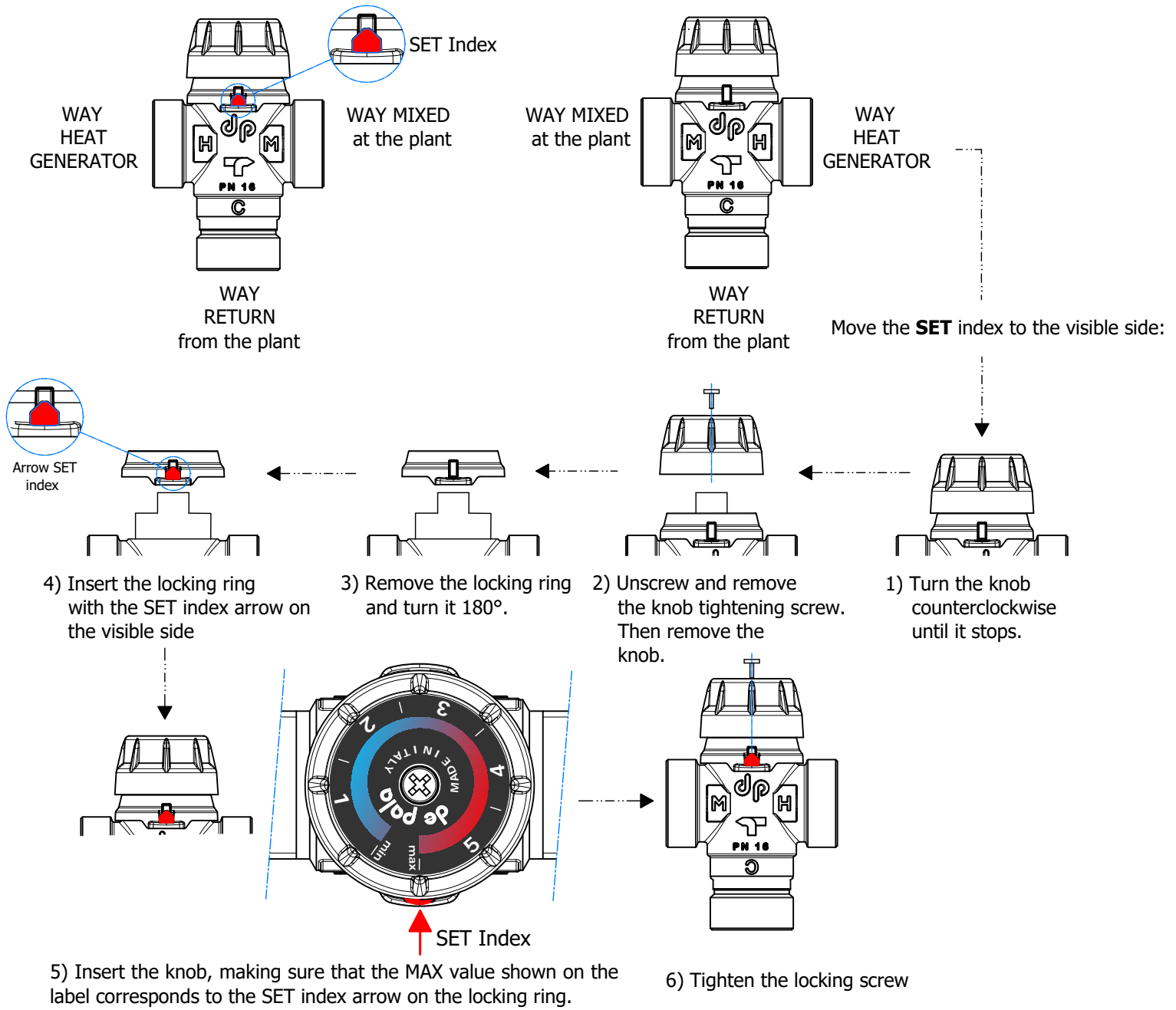

**METHOD OF GRIPPING WITH TOOL**

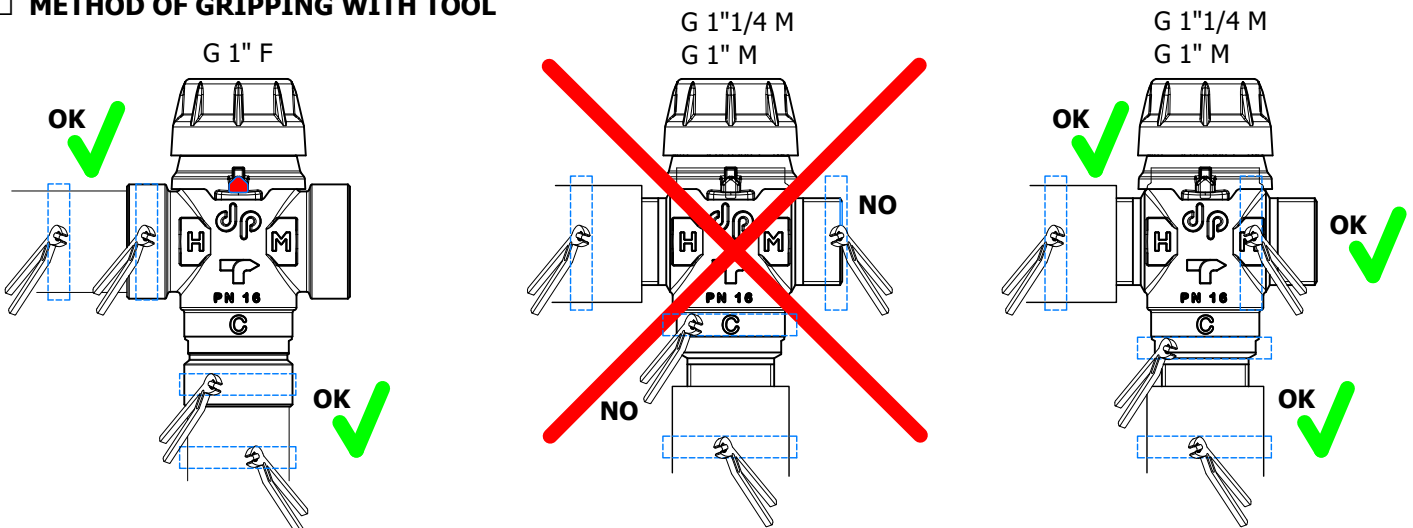

## ❑ INSTALLATION AND WATER LOADING

After turning the knob to the **MAX** position (maximum temperature **SET** adjustment), it is recommended to load the heating system using the "H" or "M" ports. The "C" port will remain closed.

## ❑ MAINTENANCE

Calcification, clogging due to corrosion residues and/or bacterial proliferation can reduce the mixing capacity of the valve. If this occurs, clean the valve chamber and internal components (shutter, thermostatic element, lower plate, spring). To do this, the valve must be removed from the system.

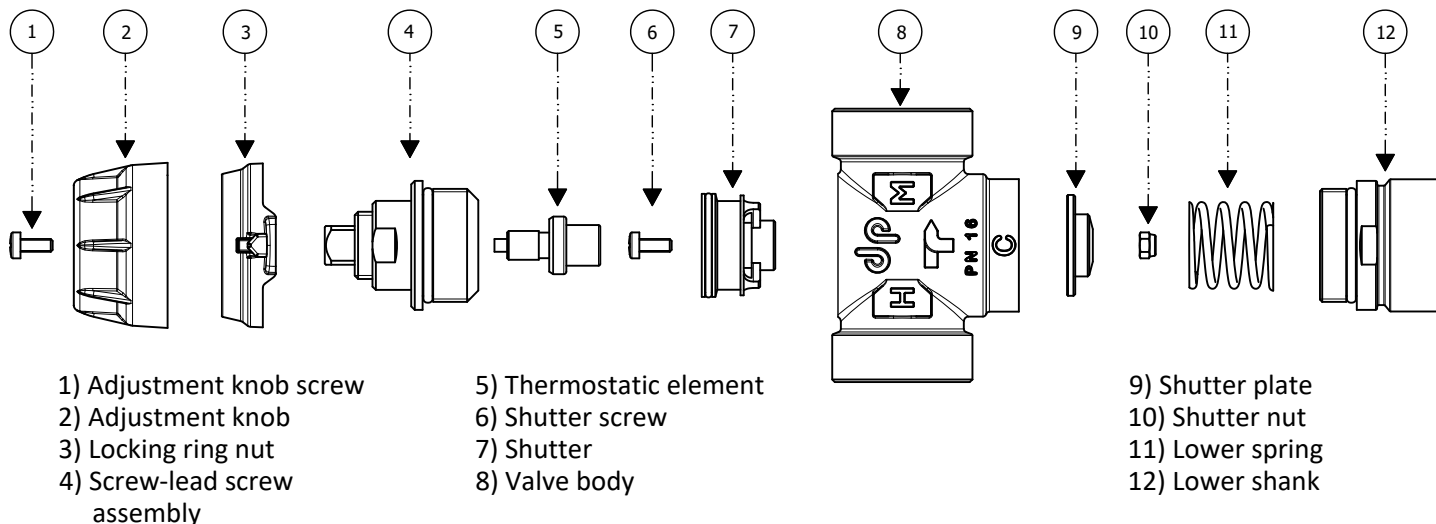

Note: when reassembling the valve, pay attention to details 2-3-4:

- 1) Mount the screw-lead screw assembly (part 4) on the valve body (part 8).
- 2) Completely unscrew the screw until it reaches the stop on the screw-lead screw assembly (part 4). Make sure that the lead screw remains tightly screwed to the valve body.
- 3) Insert the locking ring (part 3) with the SET index facing the desired side of the valve body (part 8).
- 4) Position the adjustment knob (part 2) on the screw panel, taking care to align the MAX indicator on the knob with the SET index on the locking ring (part 3).

## ❑ APPLICATION EXAMPLE

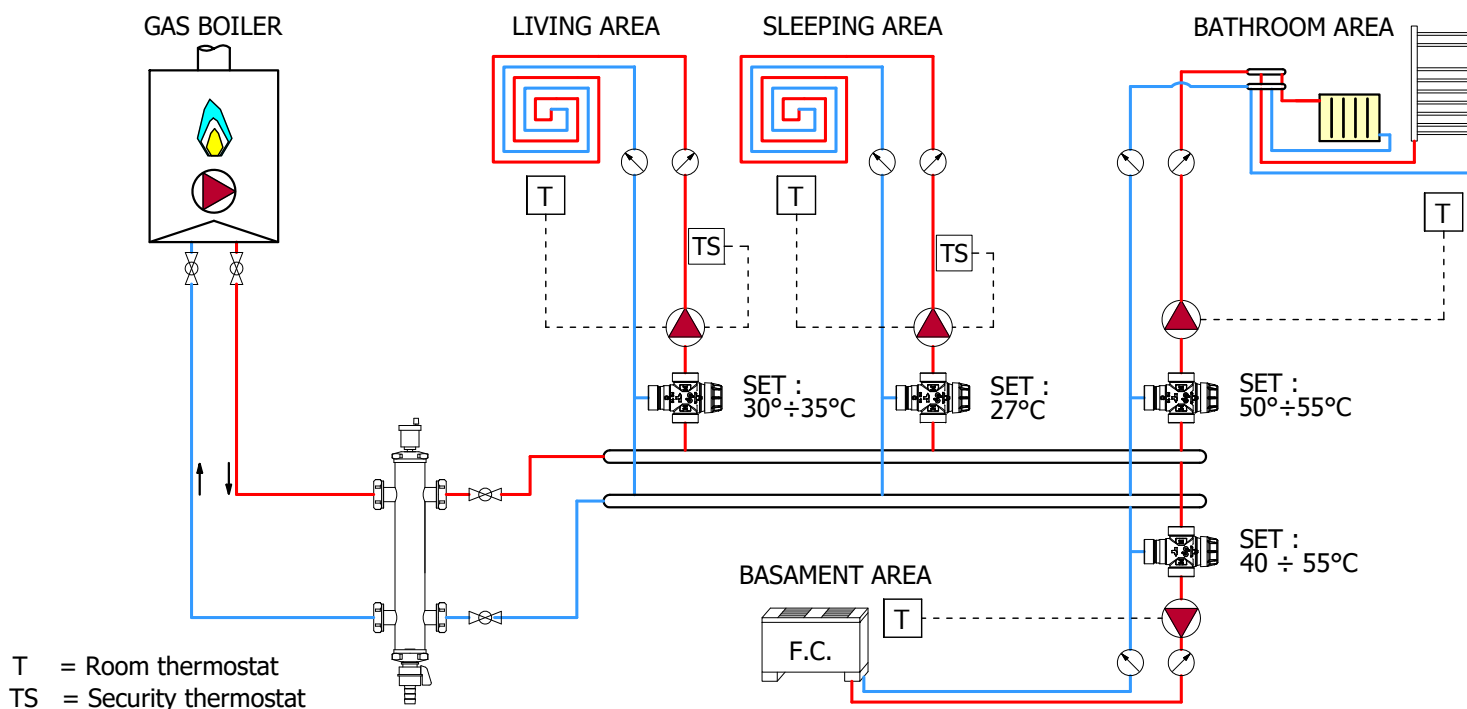

**de pala**

The information contained in this document is intended for the company responsible for installation and maintenance. Plumbing and electrical installation must be carried out by qualified personnel in accordance with the laws and regulations of each country where the product is intended for use. The product must only be used in the application for which it was designed. De Pala srl, in its ongoing process of improving its products, reserves the right to make any technical, dimensional, and aesthetic changes it deems necessary without prior notice.

33080 ROVEREDO IN PIANO ( Pordenone )  
Telefono 0434.920466 0434.923166

Via del Lavoro, 10 - ITALIA  
FAX 0434.591473

Web : [www.depala.it](http://www.depala.it)  
e-mail : [info@depala.it](mailto:info@depala.it)